

REVISIONS		
NO.	DESCRIPTION	DATE

CONTRACTOR SHALL KEEP 11' MINIMUM LANES UNLESS NOTED OTHERWISE.

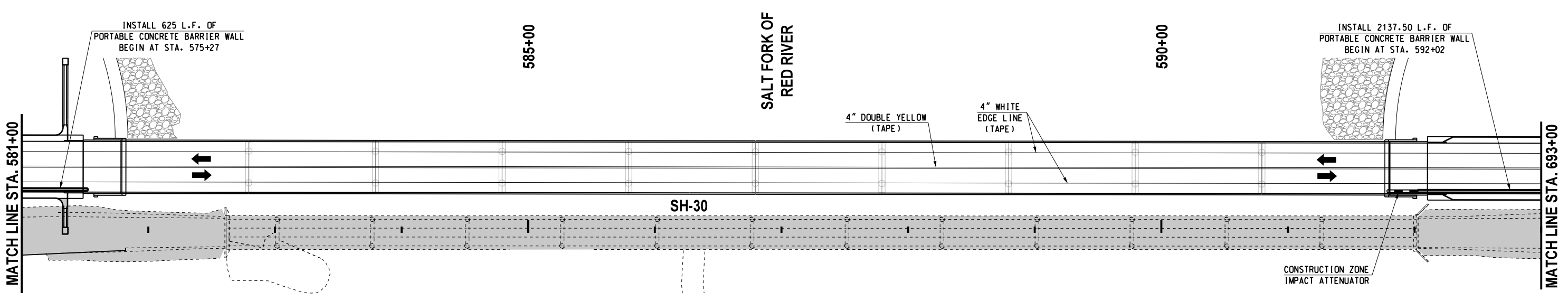
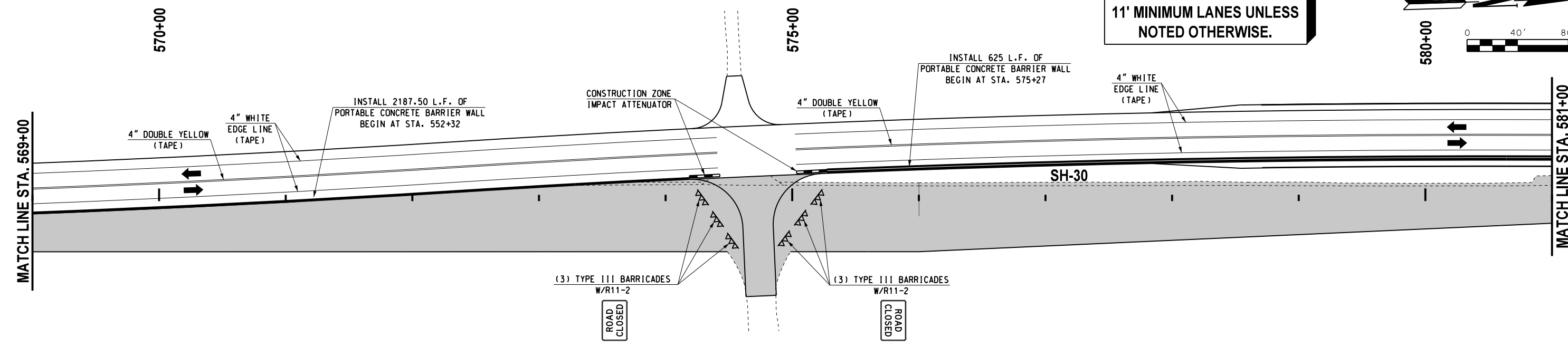
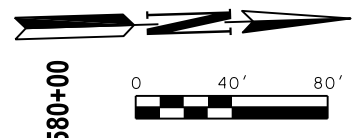

SUGGESTED SEQUENCE OF CONSTRUCTION

- PHASE 4. SHIFT TRAFFIC WEST TO NEW BRIDGE AND PAVING OF SH-30 (ONE LANE EACH DIRECTION)
- RELOCATE PORTABLE LONGITUDINAL BARRIER ALONG EAST EDGE OF DETOURED NORTHBOUND LANE
 - REMOVE EXISTING BRIDGE
 - REMOVE EXIST. ROADWAY. FINISH CONSTRUCTION OF REMAINDER OF SH-30 PAVING AND DRAINAGE (C.R.L. SH-30 STA. 563+79.97 TO STA. 576+00 AND STA. 596+00 TO STA. 613+00)

LEGEND	
	- TYPE III BARRICADE W/ TWO TYPE "A" LIGHTS
	- DRUM
	- CHANNELIZER CONE
	- PORTABLE CONC. BARRIER WALL
	- CONSTRUCTION ZONE IMPACT ATTENUATOR
	- WORK AREA

Design	RWR	9/13/2016
Drawn	CCC	9/13/2016

TRAFFIC CONTROL PLANS
PHASE 4
(2 OF 3)

State Job No. 28768(04) Sheet No. 77

9/13/2016 G:\00\Projects\1-2356 SH 30 over Salt Fork of Red River\CAD\TC PHASE 4\BC - 2.dgn

S.H. 30 BRIDGE & APPROACHES HARMON COUNTY